

EPPING FOREST DISTRICT COUNCIL - MEMORANDUM

From: District Secretary

To: LLC. Section

Originator: G. Lunnun
Ref: S/GL/TP/1/1
Date: 24 May 1978

Originator:
Ref:
Date:

Town and Country Planning General Development
Order 1977
Land at Little Stiles, Back Lane, Nazeing.

I refer to my memorandum dated 3 March 1978
and attach a copy of an amended direction which
has been sent to the Secretary of State for
the Environment for approval. I shall advise
you of his decision, in due course.

District Secretary.

JMB

Local Land Charges Section

District Secretary

District Planning Officer

G. Lunnun
S/GL/TP/1/1
24 November 1978

PL/3037/AJBR/MB

98/2

Article 4 Direction - 24 Acres of Land at Little Stiles,
Back Lane, Nazeing

... I refer to your memorandum dated 6 September 1978 and attach for your
attention a copy of the Article 4 Direction approved by the Secretary
of State for the Environment without amendment. I am arranging to
serve a Notice on the known owners and occupiers of the land and to
place a Notice in the Gazette and Independent and London Gazette on
Friday 8 December 1978, and the Direction will come into force on that
date.

District Secretary

c.c. Local Land Charges Section

DISTRICT OF EPPING FOREST

TOWN AND COUNTRY PLANNING ACT 1971

TOWN AND COUNTRY PLANNING GENERAL DEVELOPMENT
ORDER 1977

DIRECTION RESTRICTING PERMITTED DEVELOPMENT OF APPROX. 24 ACRES OF LAND AT
LITTLE STILES, BACK LANE, NAZEING, ESSEX.

WHEREAS:

- (1) The District Council of Epping Forest (hereinafter referred to as "the District Council") is the District Planning Authority under the Town and Country Planning Act 1971 (as amended by section 182 of the Local Government Act 1972) for the District of Epping Forest
- (2) Article 3 of the Town and Country Planning General Development Order 1977 (hereinafter called "the Order") permits the carrying out of certain development as specified in schedule 1 to the Order upon land to which the Order applies without the permission of the District Council or the Secretary of State for the Environment
- (3) Class VI-I of schedule 1 to the Order relates to the carrying out on agricultural land having an area of more than one acre and comprised in an agricultural unit of building or engineering operations requisite for the use of that land for the purpose of agriculture (other than the placing on land of structures not designed for those purposes or the provision and alteration of dwellings) so long as
 - (a) the ground area covered by a building erected pursuant to the permission does not, either by itself or after the addition thereto of the ground area covered by any existing building or buildings (other than a dwelling house) within the same unit erected or in the course of erection within the preceding two years and wholly or partly within 90 metres of the nearest part of the said building, exceed 465 square metres
 - (b) the height of any buildings or works does not exceed 3 metres in the case of a building or works within 3 kilometres of the perimeter of an aerodrome, nor 12 metres in any other case
 - (c) no part of any buildings (other than moveable structures) or works is within 25 metres of the metalled portion of a trunk or classified road
- (4) Article 4 of the Order enables either the District Council or the Secretary of State for the Environment to direct that a permission granted by Article 3 of the Order shall not apply to specified development

1492

ASSISTING OFFICER

A. Campbell-Jones

ATTESTING OFFICER

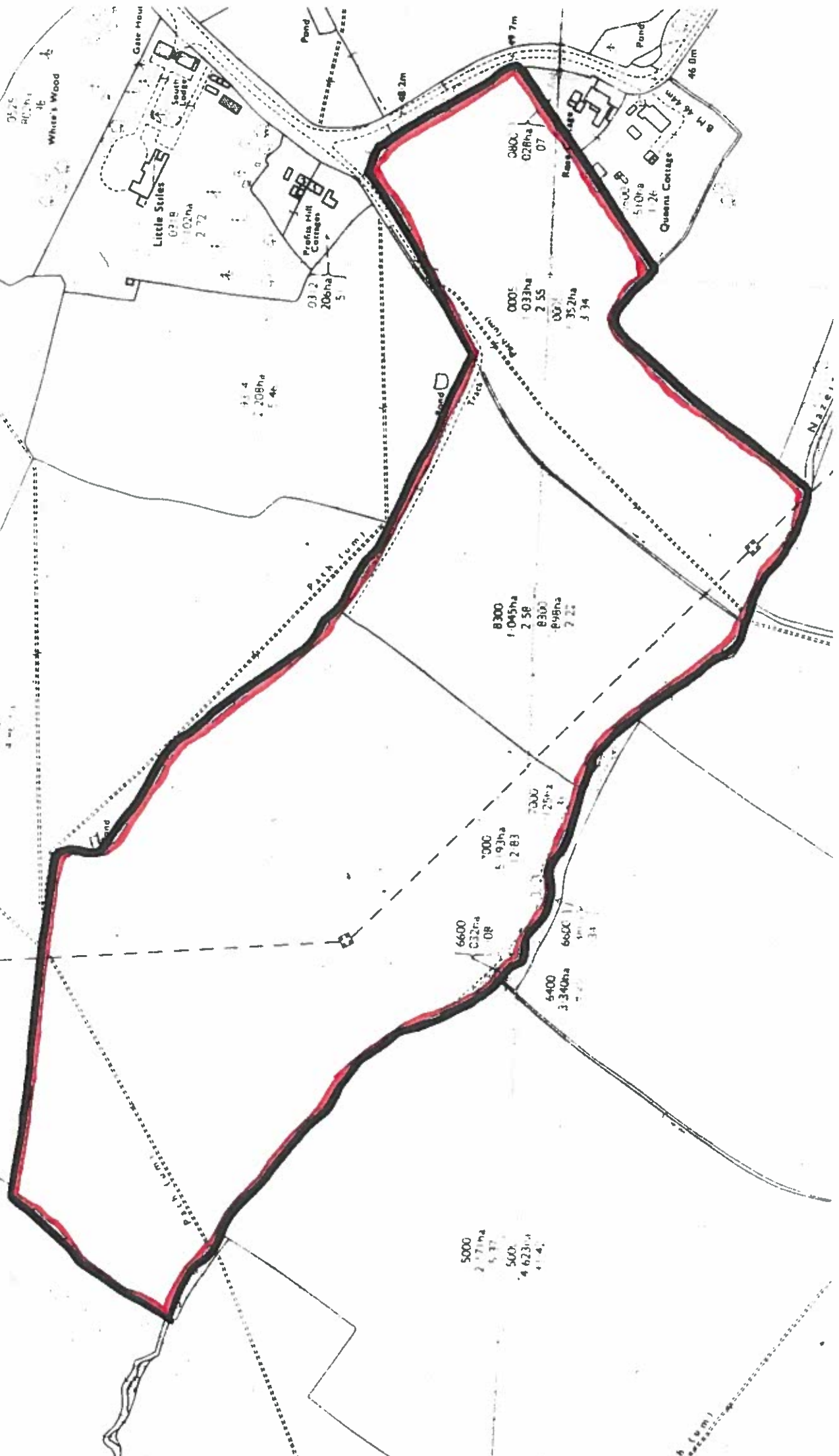

(5) The District Council is satisfied that the development specified in Class VI-I of schedule 1 of the Order should not at any time be carried out on the land hereinafter defined unless permission is granted on an application made pursuant to the provisions of the Order because the land is (i) within the Metropolitan Green Belt as defined by the County of Essex Approved Review Development Plan, where it is intended that open countryside should be preserved; (ii) within an area of fine traditional landscape quality which it is the District Council's policy to protect from radical or unsympathetic change; and because uncontrolled development of the Class so specified would constitute a threat to the openness and landscape qualities of the land hereinafter defined

N O W T H E R E F O R E the District Council in pursuance of the powers conferred upon it by sub-section (1) of Article 4 of the Order DO HEREBY DIRECT that the permission granted by Article 3 of the Order shall not apply to the development specified in Class VI-I of schedule 1. of the Order in respect of approximately 24 acres of land at Little Stiles, Back Lane, Nazeing in the district of Epping Forest more particularly delineated on the plan attached hereto and thereon edged red

This direction shall require the approval of the Secretary of State for the Environment and shall come into force on the date on which the District Council serve a notice on the occupier or if no occupier the owner of the land stating the effect of the direction after approval of the Secretary of State

Dated this 19 day of May 1978

THE COMMON SEAL of the)
DISTRICT COUNCIL OF EPPING)
FOREST was hereunto affixed)
in the presence of:-)

Attesting Officer

Attesting Officer

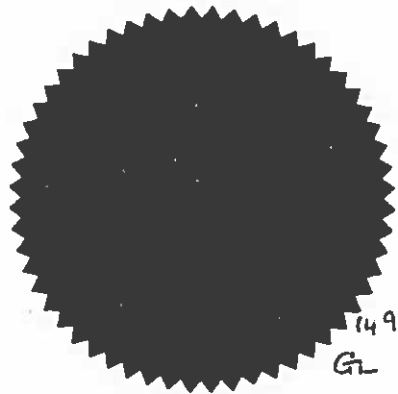

1492
GL